



Models

Colour

 Black

Ref:

97067-200827

Technical Details

MAX power	7 W
Tension	220-240V AC
Frequency	50-60 Hz
electrical insulation class	II
Screw	GU10
Light points	1
Light Source	GU10 Bulb
Use	Indoor
IP protection	IP20
Material	Metal

Height	165 mm
Width	112 mm
Length	217 mm
Cable length	1600 mm
Working temperature	0 °C~+0 °C
Ambient Working Temperature	0 °C~+0 °C
Not included	Bulbs
Certificates	RoHS, CE, UKCA
Warranty	5 Years
Colour	Black



Ambience



Measures

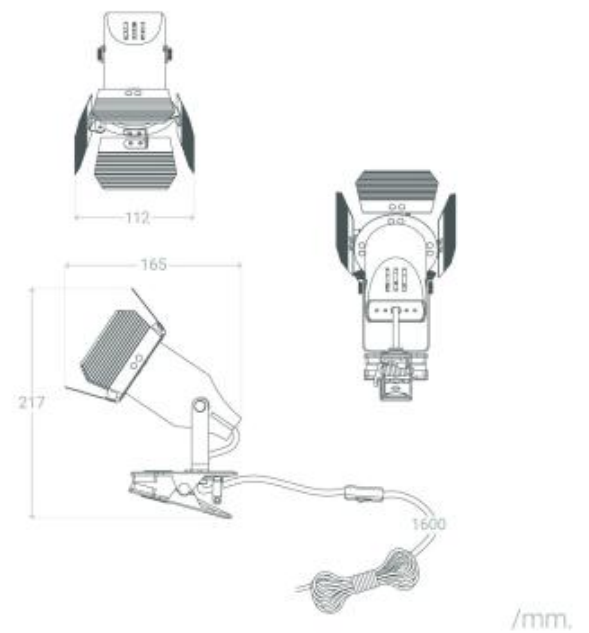



Description

The **Kurangna Clamp Lamp** is specially designed for indoor use. Its elegant and modern design makes it an ideal complement for any room. This type of lamp is perfect for decorating your home or business premises.

x000D

Features of the Kurangna Clamp Lamp

The **Kurangna Clamp Lamp** has an original design. The light it produces will depend on the GU10 LED bulb installed, as we can choose a warm, cold or neutral light depending on the desired atmosphere. An interesting option is the RGB or CCT bulbs, as they will give us extra versatility when it comes to lighting up the space. It is suitable for home decoration as well as for any shop. In addition, it has an adjustable bracket that allows us to adjust it in different ways.

x000D

It is used in a wide variety of environments such as dining rooms, bedrooms, living rooms, restaurants, cafés, etc.

Discover all the decorative options offered by the range of Clamp Lamps in our online shop Ledkia.

x000D

Uses 1 GU10 bulb NOT INCLUDED in the product.



Additional photographs

